

Ultra-Torr Vacuum Fittings



- Stainless steel construction, fluorocarbon FKM O-ring
- Reliable, repeatable sealing performance
- Available in tube sizes from 1/16 to 1 1/2 in.

Features

Seal performance is maintained through repeated disconnects.

O-ring seals to glass, metal, or plastic tubing.

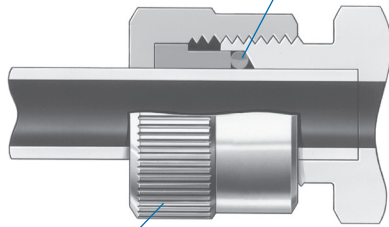

Knurled nut for easy, finger-tight assembly.

Materials of Construction

- Body, nut, and sleeve: stainless steel
- O-ring: 70 durometer fluorocarbon FKM, wetted with a thin film of silicone vacuum grease.

Temperature Rating

Standard fluorocarbon FKM O-ring, -25 to 400°F (-31 to 204°C)

Testing

The ultra-torr fitting design has been helium leak tested to a maximum leak rate of 4×10^{-9} std cm³/s at ambient temperature. The leak rate increases as temperature increases due to permeation through the O-ring.

Cleaning and Packaging

Swagelok ultra-torr vacuum fittings are cleaned to remove machine oil, grease, and loose particles. For more information, see Swagelok *Standard Cleaning and Packaging (SC-10)* (MS-06-62).

Ordering Information and Dimensions

- Dimensions are for reference only and are subject to change.
- The E dimension refers to the smallest nominal inside diameter of the part.
- To order straight fittings bored through, add **BT** to the ordering number.

Example: SS-1-UT-6BT

Union

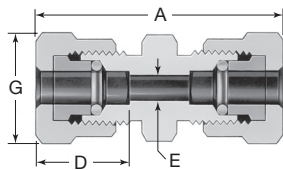

Tube OD in.	Ordering Number	Dimensions, in. (mm)			
		A	D	E	G
1/16	SS-1-UT-6	1.23 (31.2)	0.45 (11.4)	0.05 (1.3)	3/8
1/8	SS-2-UT-6	1.48 (37.6)	0.47 (11.9)	0.09 (2.3)	9/16
1/4	SS-4-UT-6	1.65 (41.9)	0.62 (15.7)	0.19 (4.8)	11/16
3/8	SS-6-UT-6	1.83 (46.5)	0.66 (16.8)	0.28 (7.1)	13/16
1/2	SS-8-UT-6	1.85 (47.0)	0.81 (20.6)	0.41 (10.4)	15/16
5/8	SS-10-UT-6	1.94 (49.3)	0.89 (22.6)	0.50 (12.7)	1 1/8
3/4	SS-12-UT-6	2.17 (55.1)	0.99 (25.1)	0.63 (16.0)	1 1/4
1	SS-16-UT-6	2.27 (57.7)	0.99 (25.1)	0.88 (22.4)	1 9/16
1 1/2	SS-24-UT-6	2.39 (60.7)	0.99 (25.1)	1.38 (35.1)	2 1/16

Reducing Union

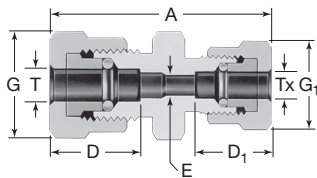

Tube OD, in.		Ordering Number	Dimensions, in. (mm)					
T	Tx		A	D	D ₁	E	G	G ₁
3/8	1/4	SS-6-UT-6-4	1.74 (44.2)	0.66 (16.8)	0.62 (15.7)	0.19 (4.8)	13/16	11/16
1/2		SS-8-UT-6-4	1.77 (45.0)	0.81 (20.6)			15/16	

Union Elbow

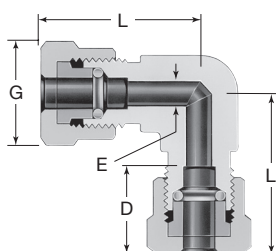

Tube OD in.	Ordering Number	Dimensions, in. (mm)			
		D	E	G	L
1/4	SS-4-UT-9	0.62 (15.7)	0.19 (4.8)	11/16	1.15 (29.2)
3/8	SS-6-UT-9	0.66 (16.8)	0.28 (7.1)	13/16	1.37 (34.8)
1/2	SS-8-UT-9	0.81 (20.6)	0.41 (10.4)	15/16	1.37 (34.8)

Ordering Information and Dimensions

Union Tee

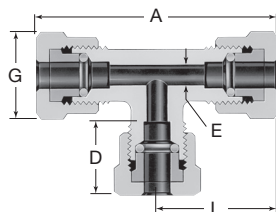

Tube OD in.	Ordering Number	Dimensions, in. (mm)				
		A	D	E	G	L
1/8	SS-2-UT-3	2.20 (55.9)	0.47 (11.9)	0.09 (2.3)	9/16	1.10 (27.9)
1/4	SS-4-UT-3	2.32 (58.9)	0.62 (15.7)	0.19 (4.8)	11/16	1.16 (29.5)
3/8	SS-6-UT-3	2.74 (69.6)	0.66 (16.8)	0.28 (7.1)	13/16	1.37 (34.8)
1/2	SS-8-UT-3	2.74 (69.6)	0.81 (20.6)	0.41 (10.4)	15/16	1.37 (34.8)
3/4	SS-12-UT-3	3.42 (86.9)	0.99 (25.1)	0.63 (16.0)	1 1/4	1.71 (43.3)
1	SS-16-UT-3	3.76 (95.5)	0.99 (25.1)	0.88 (22.4)	1 9/16	1.88 (47.8)

Male Connector

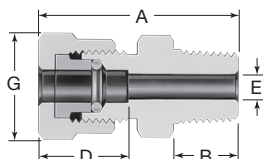

Tube OD in.	NPT Size in.	Ordering Number	Dimensions, in. (mm)				
			A	B	D	E	G
1/16	1/8	SS-1-UT-1-2	1.14 (29.0)	0.38 (9.6)	0.45 (11.4)	0.05 (1.3)	3/8
1/8	1/8	SS-2-UT-1-2	1.26 (32.0)	0.38 (9.6)	0.47 (11.9)	0.09 (2.3)	9/16
1/4	1/8	SS-4-UT-1-2	1.36 (34.5)	0.38 (9.6)	0.62 (15.7)	0.19 (4.8)	11/16
	1/4	SS-4-UT-1-4	1.54 (39.1)	0.56 (14.2)			
3/8	1/8	SS-6-UT-1-2	1.45 (36.8)	0.38 (9.6)	0.66 (16.8)	0.19 (4.8) 0.28 (7.1)	13/16
	1/4	SS-6-UT-1-4	1.63 (41.4)	0.56 (14.2)			
1/2	3/8	SS-8-UT-1-6	1.66 (42.2)	0.56 (14.2)	0.81 (20.6)	0.41 (10.4)	15/16
	1/2	SS-8-UT-1-8	1.85 (47.0)	0.75 (19.1)			
3/4	3/4	SS-12-UT-1-12	2.02 (51.3)	0.75 (19.1)	0.99 (25.1)	0.63 (16.0)	1 1/4
1	1	SS-16-UT-1-16	2.31 (58.7)	0.94 (23.9)	0.99 (25.1)	0.88 (22.4)	1 9/16

Swagelok Tube Fitting Union

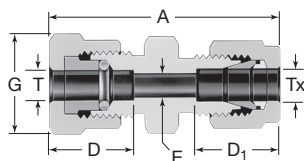

Tube OD, in.		Ordering Number	Dimensions, in. (mm)				
T	Tx		A	D	D ₁	E	G
1/4	1/4	SS-4-UT-6-400	1.67 (42.4)	0.62 (15.7)	0.60 (15.2)	0.19 (4.8)	11/16
3/8	3/8	SS-6-UT-6-600	1.82 (46.2)	0.66 (16.8)	0.66 (16.8)	0.28 (7.1)	13/16
1/2	1/2	SS-8-UT-6-810	1.96 (49.8)	0.81 (20.6)	0.90 (22.9)	0.41 (10.4)	15/16

Dimensions shown with Swagelok nuts finger-tight.

Adapter

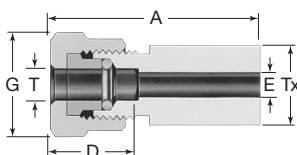

Tube OD, in.		Ordering Number	Dimensions, in. (mm)			
T	Tx		A	D	E	G
1/16	1/4	SS-1-UT-A-4	1.14 (29.0)	0.45 (11.4)	0.05 (1.3)	3/8
1/8	1/4	SS-2-UT-A-4	1.24 (31.5)	0.47 (11.9)	0.09 (2.3)	9/16
	3/8	SS-2-UT-A-6	1.25 (31.8)			
1/4	1/4	SS-4-UT-A-4 ^①	1.35 (34.3)	0.62 (15.7)	0.19 (4.8)	11/16
	3/8	SS-4-UT-A-6	1.34 (34.0)			
3/8	1/2	SS-4-UT-A-8	1.48 (37.6)	0.66 (16.8)	0.28 (7.1)	13/16
	3/8	SS-6-UT-A-6 ^①	1.48 (37.6)			
1/2	1/2	SS-6-UT-A-8	1.59 (40.4)	0.81 (20.6)	0.41 (10.4)	15/16
	5/8	SS-8-UT-A-10	1.65 (41.9)			
3/4	3/4	SS-8-UT-A-12	1.70 (43.2)	0.99 (25.1)	0.63 (16.0)	1 1/4
3/4	1	SS-12-UT-A-16	1.84 (46.7)			
1	1 1/4	SS-16-UT-A-20	1.86 (47.2)	0.99 (25.1)	0.88 (22.4)	1 9/16
1 1/2	1 1/2	SS-24-UT-A-24 ^①	2.04 (51.8)			

^① Not available bored through.

Ordering Information and Dimensions

Nuts

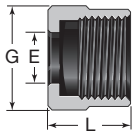

Tube OD in.	Ordering Number	Thread Size	Dimensions, in. (mm)		
			E	L	G
1/16	SS-1-UTN	1/4-20 UNC	0.07 (1.8)	0.38 (9.6)	3/8
1/8	SS-2-UTN	3/8-20 UN	0.13 (3.3)	0.41 (10.4)	9/16
1/4	SS-4-UTN	1/2-20 UNF	0.26 (6.6)	0.53 (13.5)	11/16
3/8	SS-6-UTN	5/8-20 UN	0.38 (9.6)	0.62 (15.7)	13/16
1/2	SS-8-UTN	3/4-20 UNEF	0.51 (13.0)	0.62 (15.7)	15/16
5/8	SS-10-UTN	15/16-20 UNEF	0.63 (16.0)	0.62 (15.7)	1 1/8
3/4	SS-12-UTN	1 1/16-20 UN	0.76 (19.3)	0.72 (18.3)	1 1/4
1	SS-16-UTN	1 3/8-20 UN	1.01 (25.6)	0.72 (18.3)	1 9/16
1 1/2	SS-24-UTN	1 7/8-20 UN	1.51 (38.4)	0.72 (18.3)	2 1/16

O-Rings



Tube OD in.	Uniform Size Number	Ordering Number
1/16	001-1/2 ^①	VT-7-OR-001-1/2
1/8	006	VT-7-OR-006
1/4	010	VT-7-OR-010
3/8	012	VT-7-OR-012
1/2	014	VT-7-OR-014
5/8	114	VT-7-OR-114
3/4	116	VT-7-OR-116
1	120	VT-7-OR-120
1 1/2	128	VT-7-OR-128

^① Not a uniform O-ring size.

Safe Product Selection

When selecting a product, the total system design must be considered to ensure safe, trouble-free performance. Function, material compatibility, adequate ratings, proper installation, operation, and maintenance are the responsibilities of the system designer and user.

⚠️ WARNING

Do not mix/interchange Swagelok products or components not governed by industrial design standards, including Swagelok tube fitting end connections, with those of other manufacturers.

Warranty Information

Swagelok products are backed by The Swagelok Limited Lifetime Warranty. For a copy, visit swagelok.com or contact your authorized Swagelok representative.